

A REPLAT OF LOT 1 BLOCK 1 OF NEW HAVEN OF REILE'S ACRES 2ND ADDITION
TO THE CITY OF REILE'S ACRES, CASS COUNTY, NORTH DAKOTA

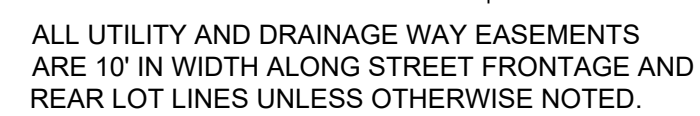

BASIS OF BEARING:
NAD83-NORTH DAKOTA STATE PLANE-SOUTH ZONE- INTERNATIONAL FEET

1. PART OF THIS PLAT FALLS IN FLOODPLAIN ZONE 'AE' PER FEMA FIRM MAP 38017C0578G WITH AN EFFECTIVE DATE OF 1/16/2015. WITH A BASE FLOOD ELEVATION OF 894.00' NAVD88.



- SHEET 1 OF 2

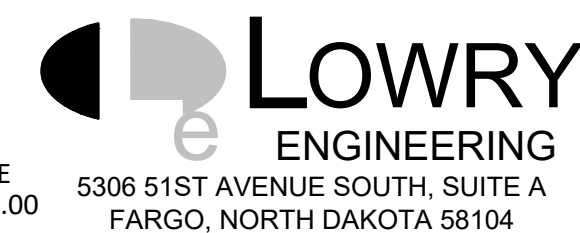

NEW HAVEN OF REILE'S ACRES 4TH ADDITION

A REPLAT OF LOT 1 BLOCK 1 OF NEW HAVEN OF REILE'S ACRES 2ND ADDITION
TO THE CITY OF REILE'S ACRES, CASS COUNTY, NORTH DAKOTA

OWNERS' CERTIFICATE

KNOW ALL MEN BY THESE PRESENTS, THAT NEW HAVEN INVESTMENTS LLC, IS THE OWNER OF THAT PART OF LOT 1 BLOCK 1 , OF NEW HAVEN OF REILE'S ACRES 2ND ADDITION TO THE CITY OF REILE'S ACRES, COUNTY OF CASS, STATE OF NORTH DAKOTA AND MORE PARTICULARLY DESCRIBED AS FOLLOWS:

LOT ONE, BLOCK ONE, NEW HAVEN OF REILE'S ACRES 2ND ADDITION TO THE CITY OF REILE'S ACRES, SITUATE IN THE COUNTY OF CASS AND THE STATE OF NORTH DAKOTA.

SAID OWNER HAS CAUSED THE ABOVE DESCRIBED TRACT OF LAND SHOWN ON THIS PLAT TO BE SURVEYED AND PLATTED AS NEW HAVEN OF REILE'S ACRES 4TH ADDITION TO THE CITY OF REILE'S ACRES, NORTH DAKOTA. SAID OWNER ALSO HEREBY DEDICATES AND CONVEYS TO THE PUBLIC, FOR PUBLIC USE, ALL STREET RIGHT OF WAYS, UTILITY EASEMENTS, UTILITY & DRAINAGE EASEMENTS SHOWN ON SAID PLAT. SAID OWNER ALSO HEREBY DEDICATES LOT 1 BLOCK 1 AND LOT 6 BLOCK 2 TO THE CITY OF REILE'S ACRES. SAID NEW HAVEN OF REILE'S ACRES 4TH ADDITION, CONSISTS OF 42 LOTS AND 3 BLOCKS, AND CONTAINS 43.06 ACRES, MORE OR LESS TOGETHER WITH EASEMENTS AND RIGHT OF WAYS OF RECORD.

NEW HAVEN INVESTMENTS LLC
BY: JUSTIN BERG
ITS: CHIEF EXECUTIVE MANAGER

STATE OF _____)
COUNTY OF _____)SS

ON THIS _____ DAY OF _____, 2025, BEFORE ME, A NOTARY PUBLIC WITHIN AND FOR SAID COUNTY AND STATE, PERSONALLY APPEARED _____, TO ME KNOWN TO BE THE PERSON DESCRIBED IN AND WHO EXECUTED THE FOREGOING INSTRUMENT AND ACKNOWLEDGED THAT HE EXECUTED SAME AS THEIR FREE ACT AND DEED.

NOTARY PUBLIC, COUNTY: _____ STATE: _____
MY COMMISSION EXPIRES: _____

SURVEYORS CERTIFICATE

I, COLE A. NESET, REGISTERED LAND SURVEYOR UNDER THE LAWS OF THE STATE OF NORTH DAKOTA, DO HEREBY CERTIFY THAT I HAVE SURVEYED AND PLATTED THE PROPERTY DESCRIBED ON THIS PLAT AS NEW HAVEN OF REILE'S ACRES 4TH ADDITION; THAT THIS PLAT IS A CORRECT REPRESENTATION OF SAID SURVEY; THAT ALL DISTANCES ARE SHOWN CORRECTLY ON SAID PLAT IN FEET AND HUNDREDTHS OF A FOOT; THAT ALL MONUMENTS ARE OR WILL BE INSTALLED CORRECTLY IN THE GROUND AS SHOWN; AND THAT THE EXTERIOR BOUNDARY LINES ARE CORRECTLY DESIGNATED. DATED THIS _____ DAY OF _____, 2025.

COLE A. NESET,
REGISTERED LAND SURVEYOR
LS-7513

STATE OF NORTH DAKOTA)
COUNTY OF CASS)SS

ON THIS _____ DAY OF _____, 2025, BEFORE ME, A NOTARY PUBLIC WITHIN AND FOR SAID COUNTY AND STATE, PERSONALLY APPEARED COLE A. NESET, TO ME KNOWN TO BE THE PERSON DESCRIBED IN AND WHO EXECUTED THE FOREGOING INSTRUMENT AND ACKNOWLEDGED THAT HE EXECUTED SAME AS THEIR FREE ACT AND DEED.

NOTARY PUBLIC, COUNTY: CASS STATE: NORTH DAKOTA

CITY ENGINEER'S APPROVAL

THIS PLAT IN THE CITY OF REILE'S ACRES IS HEREBY APPROVED THIS _____ DAY OF _____ 2025.

ANDREW J. THILL
CITY ENGINEER

STATE OF _____)
COUNTY OF _____)SS

ON THIS _____ DAY OF _____, 2025, BEFORE ME, A NOTARY PUBLIC WITHIN AND FOR SAID COUNTY AND STATE, PERSONALLY APPEARED _____, TO ME KNOWN TO BE THE PERSON DESCRIBED IN AND WHO EXECUTED THE FOREGOING INSTRUMENT AND ACKNOWLEDGED THAT HE EXECUTED SAME AS THEIR FREE ACT AND DEED.

NOTARY PUBLIC, COUNTY: _____ STATE: _____
MY COMMISSION EXPIRES: _____

CITY COMMISSION APPROVAL

THIS PLAT IN THE CITY OF REILE'S ACRES IS HEREBY APPROVED THIS _____ DAY OF _____ 2025.

SHANE AMUNDSON
MAYOR

NIC MILLER
CITY AUDITOR

STATE OF _____)
COUNTY OF _____)SS

ON THIS _____ DAY OF _____, 2025, BEFORE ME, A NOTARY PUBLIC WITHIN AND FOR SAID COUNTY AND STATE, PERSONALLY APPEARED _____, TO ME KNOWN TO BE THE PERSON DESCRIBED IN AND WHO EXECUTED THE FOREGOING INSTRUMENT AND ACKNOWLEDGED THAT HE EXECUTED SAME AS THEIR FREE ACT AND DEED.

NOTARY PUBLIC, COUNTY: _____ STATE: _____
MY COMMISSION EXPIRES: _____

CURVE TABLE					
CURVE #	LENGTH	RADIUS	DELTA	CHORD BEARING	CHORD LENGTH
C1	55.76'	71.00'	45°00'00"	S19°50'27"W	54.34'
C2	10.03'	71.00'	8°05'37"	S38°17'38"W	10.02'
C3	45.73'	71.00'	36°54'23"	S15°47'38"W	44.95'
C4	208.13'	265.00'	45°00'00"	N19°50'27"E	202.82'
C5	66.21'	265.00'	14°18'53"	N35°11'00"E	66.04'
C6	141.92'	265.00'	30°41'07"	N12°41'00"E	140.23'
C7	263.11'	335.00'	45°00'00"	S19°50'27"W	256.40'
C8	45.14'	335.00'	7°43'11"	S38°28'52"W	45.10'
C9	77.59'	335.00'	13°16'14"	S27°59'09"W	77.42'
C10	114.10'	335.00'	19°30'51"	S11°35'37"W	113.55'
C11	26.29'	335.00'	4°29'44"	S00°24'41"E	26.28'
C12	235.70'	100.00'	135°02'47"	N25°10'56"W	184.81'
C13	29.82'	100.00'	17°05'10"	N84°09'45"W	29.71'
C14	54.52'	100.00'	31°14'13"	N60°00'03"W	53.85'
C15	54.52'	100.00'	31°14'13"	N28°45'50"W	53.85'
C16	54.52'	100.00'	31°14'13"	N02°28'24"E	53.85'
C17	42.32'	100.00'	24°14'57"	N30°12'59"E	42.01'
C18	70.71'	30.00'	135°02'47"	N25°10'56"W	55.44'
C19	47.04'	30.00'	89°50'54"	S42°22'13"W	42.37'

CURVE TABLE					
CURVE #	LENGTH	RADIUS	DELTA	CHORD BEARING	CHORD LENGTH
C20	156.81'	100.00'	89°50'54"	S42°22'13"W	141.23'
C21	10.39'	100.00'	5°57'07"	S84°19'07"W	10.38'
C22	52.12'	100.00'	29°51'36"	S66°24'45"W	51.53'
C23	54.52'	100.00'	31°14'13"	S35°51'50"W	53.85'
C24	39.79'	100.00'	22°47'57"	S08°50'45"W	39.53'
C25	78.43'	30.00'	149°47'22"	S77°26'54"E	57.93'
C26	261.43'	100.00'	149°47'22"	S77°26'54"E	193.09'
C27	31.71'	100.00'	18°10'09"	S11°38'18"E	31.58'
C28	54.52'	100.00'	31°14'13"	S36°20'28"E	53.85'
C29	54.52'	100.00'	31°14'13"	S67°34'42"E	53.85'
C30	54.52'	100.00'	31°14'13"	N81°11'05"E	53.85'
C31	66.16'	100.00'	37°54'33"	N46°36'42"E	64.96'
C32	121.73'	475.00'	14°41'02"	N34°59'56"E	121.40'
C33	45.07'	475.00'	5°26'10"	N39°37'22"E	45.05'
C34	76.67'	475.00'	9°14'52"	N32°16'51"E	76.58'
C35	139.67'	545.00'	14°41'02"	N34°59'56"E	139.29'
C36	23.55'	545.00'	2°28'34"	N41°06'10"E	23.55'
C37	116.12'	545.00'	12°12'29"	N33°45'39"E	115.90'

BLOCK 1 AREA TABLE		
LOT #	SQUARE FEET	ACRES
11	11,213	0.26
12	10,781	0.25
13	18,309	0.42
14	17,016	0.39
15	21,481	0.49
16	21,330	0.49
17	11,949	0.27
18	9,800	0.22
19	9,800	0.22
20	9,800	0.22
21	12,760	0.29
22	23,014	0.53
23	19,602	0.45
24	11,202	0.26
25	11,200	0.26
26	11,200	0.26
27	13,949	0.32
28	22,892	0.53
29	15,257	0.35
30	11,642	0.27
31	12,764	0.29
32	11,200	0.26

BLOCK 2 AREA TABLE		
LOT #	SQUARE FEET	ACRES
1	747	0.02
2	11,547	0.27
3	10,625	0.24
4	10,421	0.24
5	13,392	0.31
6	8,697	0.20

CASS COUNTY RECORDING AREA

